

LIFE URINAL

INSTALLATION INSTRUCTIONS

CODE: J6000 - Top entry
J6010 - Back entry

DESCRIPTION

The **Life Urinal** is a vitreous china wall hung urinal with a waste trap that is concealed within the unit. This 4 Star WELS rated urinal is designed to be used with a sensor activated, timed solenoid system (not supplied) Bathroom Products Australia recommends using our Schell electronic flushing system J6200 (WMKA00588) or alternatively the use of our Pull Chain cistern RG21015PC (WMKA20080) . An Easi-fix wall mounting bracket and installation template is supplied. Both back and top water inlet models are available. A stainless steel waste dome is provided.

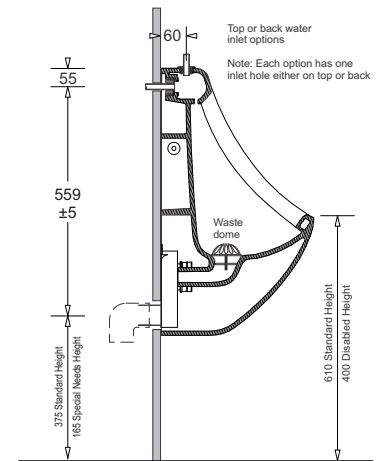
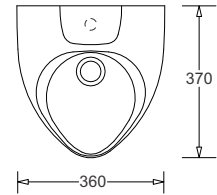
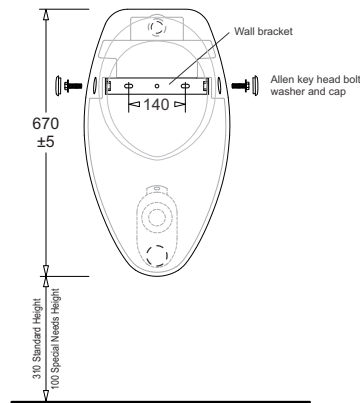

INSTALLATION STEPS

1. Inspect urinal for any transit damage before starting installation.
2. Check site roughing in and assembly dimensions before starting installation. Check-measure the water inlet/waste fitting outlet dimension to confirm installation fit.
Due to manufacturing tolerances, it is the installer's responsibility to confirm critical dimensions by measuring the urinal prior to installation. This is particularly important for the dimension between the water inlet and the waste outlet.
3. Affix the bracket-plate to the wall 145mm below the water inlet centre. Use the bracket as a template for ease of locating the fixing points
4. For concealed back water inlet ensure that the 19mm brass sparge pipe protrudes 40mm from the finished wall face. For top water inlet the pipe is fitted after mounting the urinal
5. The waste is connected to a 50mm DWV pipework.
6. For back water inlet - seat the rubber grommet seal into the recess in the back of the urinal.
7. Connect the waste trap to the pipework and affix the trap to the wall
8. Mount the urinal to the bracket ensuring the water inlet and waste outlet align and seal correctly (lubricant may be used).
9. Secure the urinal to the bracket using the bolts and attach the rubber cover caps.
10. For top water inlet - fit the rubber seal and fit the sparge pipe.
11. Fit the stainless steel waste dome into the urinal bowl.
12. Test flush and check for leaks.
13. Silicone sealant may be used to dress and seal the contact joint between the urinal and the wall.

Back Water Inlet Model: J6010

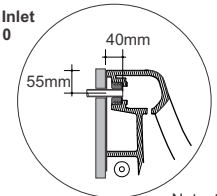

Note: the 19mm sparge pipe is not included

Top Water Inlet Model: J6000

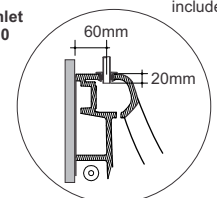

Waste Details

