

Fixing Instructions for Cotto C90801 Deluxe Soft Close Seat

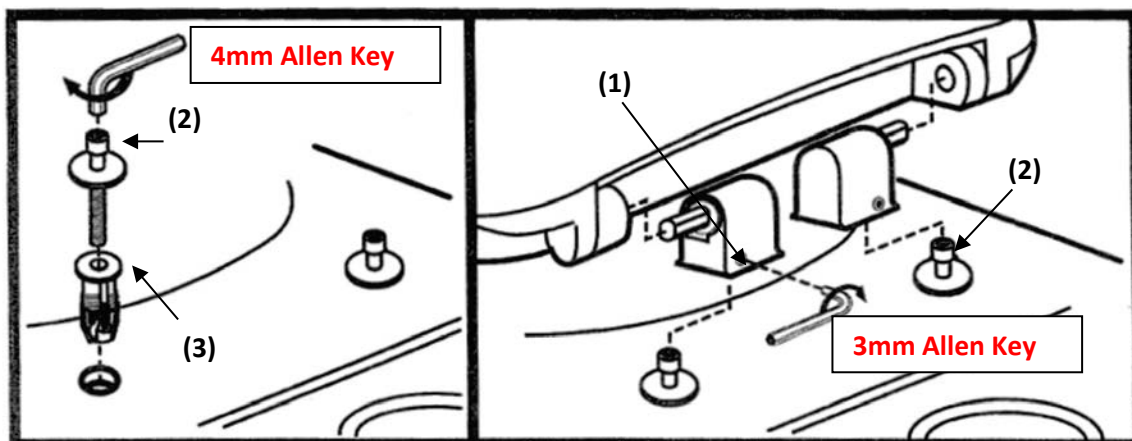

- If the seat is found to be loose, the seat will firstly need to be removed by loosening the grub screws at the back of hinge blocks **(1)**. **This requires a 3mm Allen key**
- Next the Anchor Bolt will need to be tightened. This expands the Nylon anchor fitting inside the pan. **(2) This requires a 4mm Allen Key**
If the Nylon anchor rotates in the hole, place a flathead screw driver under the lip of the flange and lever up slightly to jam anchor allowing it to be tightened **(3)**
- Once the anchors are fixed, fit the hinge blocks to the seat and refit the seat to the WC pan (Note that the hinge blocks must be fitted with the 3mm grub screw facing to the back).
- Firmly tighten the grub screws**(1)** with the 3mm Allen key.